

Blade Guards

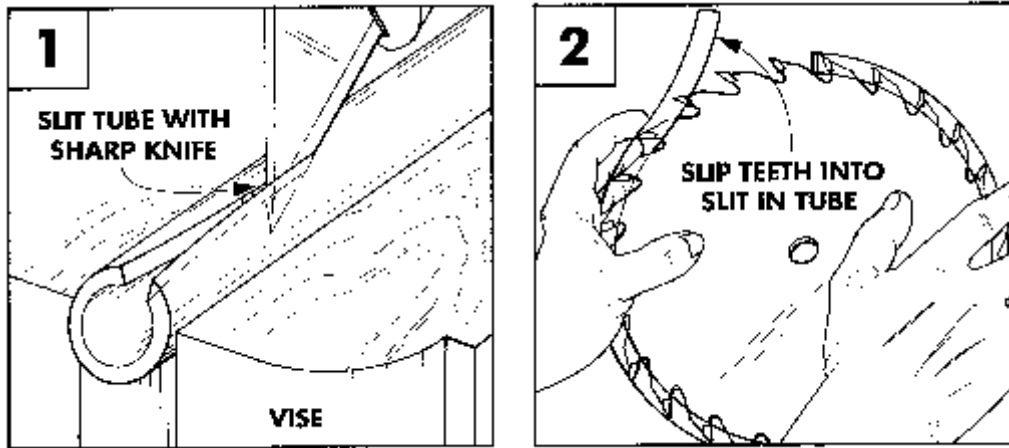

© 1995, August Home Publishing Co.

Carbide-tipped circular saw blades are expensive, so I take care to protect the teeth from damage when the blade is off the saw for storage or to be sharpened. To protect the teeth, I use a piece of plastic tubing that I bought at a hardware store, refer to Fig. 2. It costs about 20¢ a foot. (Mail order catalogues sell blade guards for \$10 or more.)

To make a guard for a 10" blade, start with a 3-foot length of 3/8" O.D. plastic tubing, or 5/16" O.D. tubing for thin kerf blades.

Then wedge the tube in a vice and slit it open with a sharp utility knife, see Fig. 1. Now spread the tubing apart and slip it over the teeth, see Fig. 2.